

TIGERGRIP | TG 16 PRO SR5

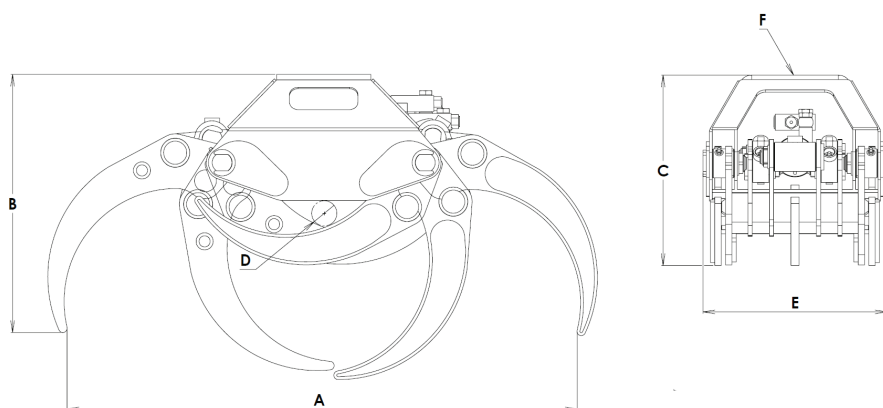

KEY FEATURES

- Double guide bars
- Optimized roll in/roll out properties
- High pressure cylinder with double piston rod seals



A	950
B	482
C	355
D	47
E	344
F	140/140-17

MODEL SPECIFICATIONS



TG 16 PRO SR5	80	0,16	200	50	7	3	1	4				
---------------	----	------	-----	----	---	---	---	---	--	--	--	--



Unit 15 Vauxhall Industrial Estate
 Greg Street, Reddish
 Stockport
 SK5 7BR
 United Kingdom
 Telephone: 0844 770 7969
 Fax: 0844 770 7979
 web: www.approvedhydraulics.co.uk